

Salon Viola

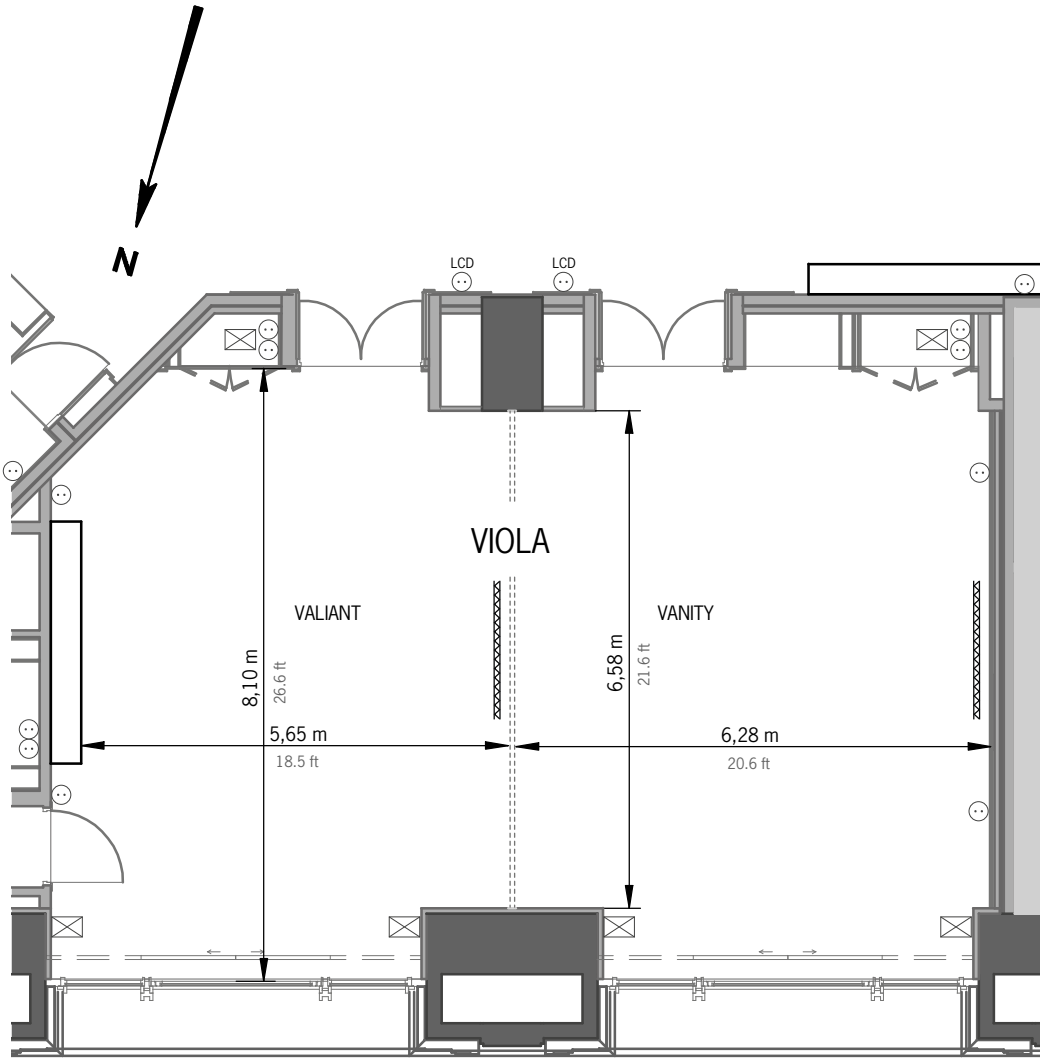

Mountain view

Legend

- 220v wall sockets
 - electrical box with power outlet
 - removable partition
 - removable screen
 - daylight
- Level: 1st floor
 Orientation: north
 Height to ceiling: 3,30 m / 10.8 ft
 Viola area: 96 sq m / 1,033.3 sq ft
 Vanity area: 49 sq m / 527.4 sq ft
 Valiant area: 47 sq m / 505.9 sq ft
- Scale: 1/100



	Board	Cabaret	Classroom	Theatre	U-shape	Hollow Square	Banquet	Cocktail
SALON VIOLA	40	56	45	100	40	52	72	80
SALON VALIANT	14	18	27	40	14	20	27	40
SALON VANITY	14	18	27	40	14	20	27	40

Scale : 1/100

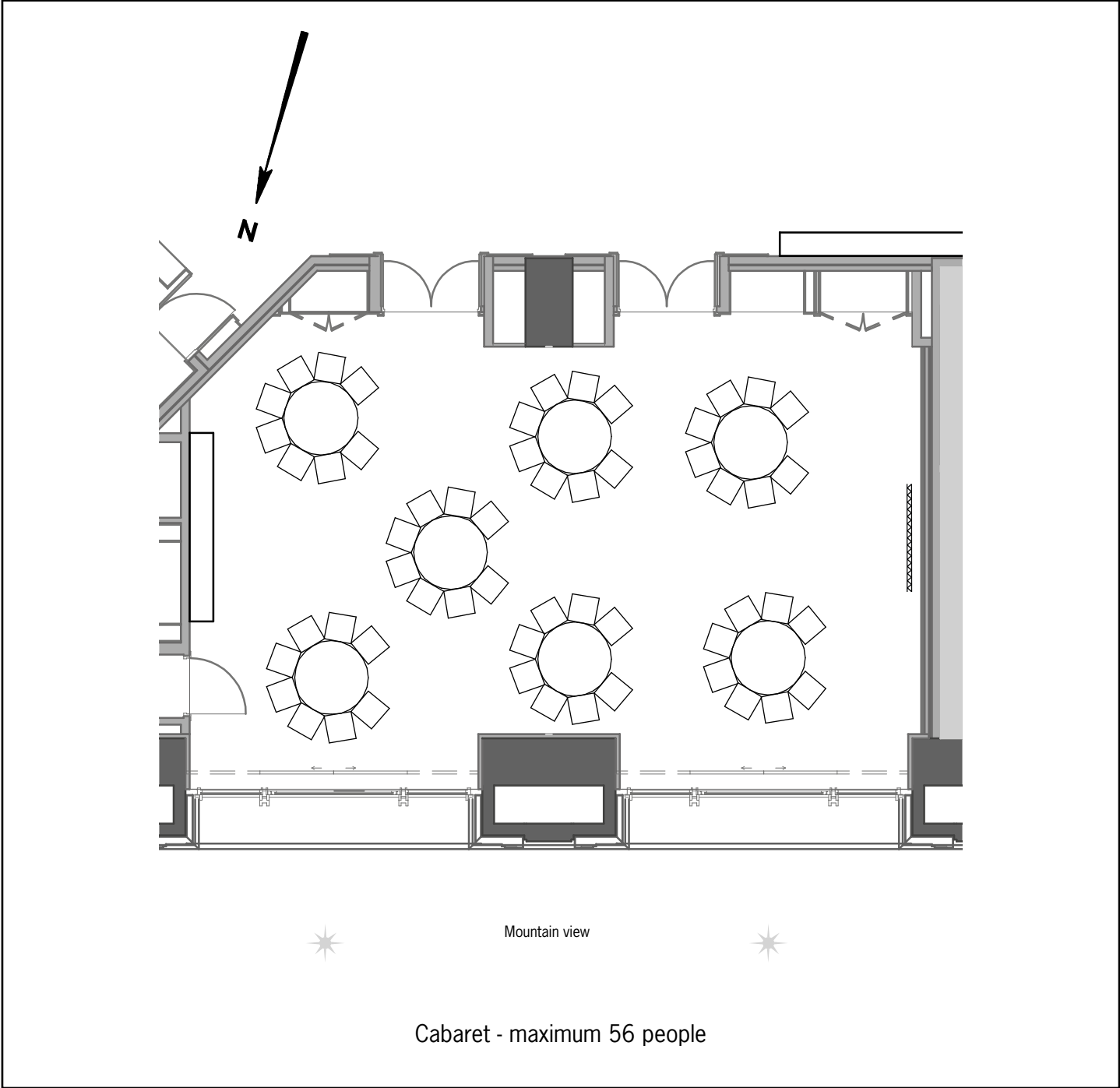

For technical information, please refer to general floorplan (without set-up)

Scale : 1/100

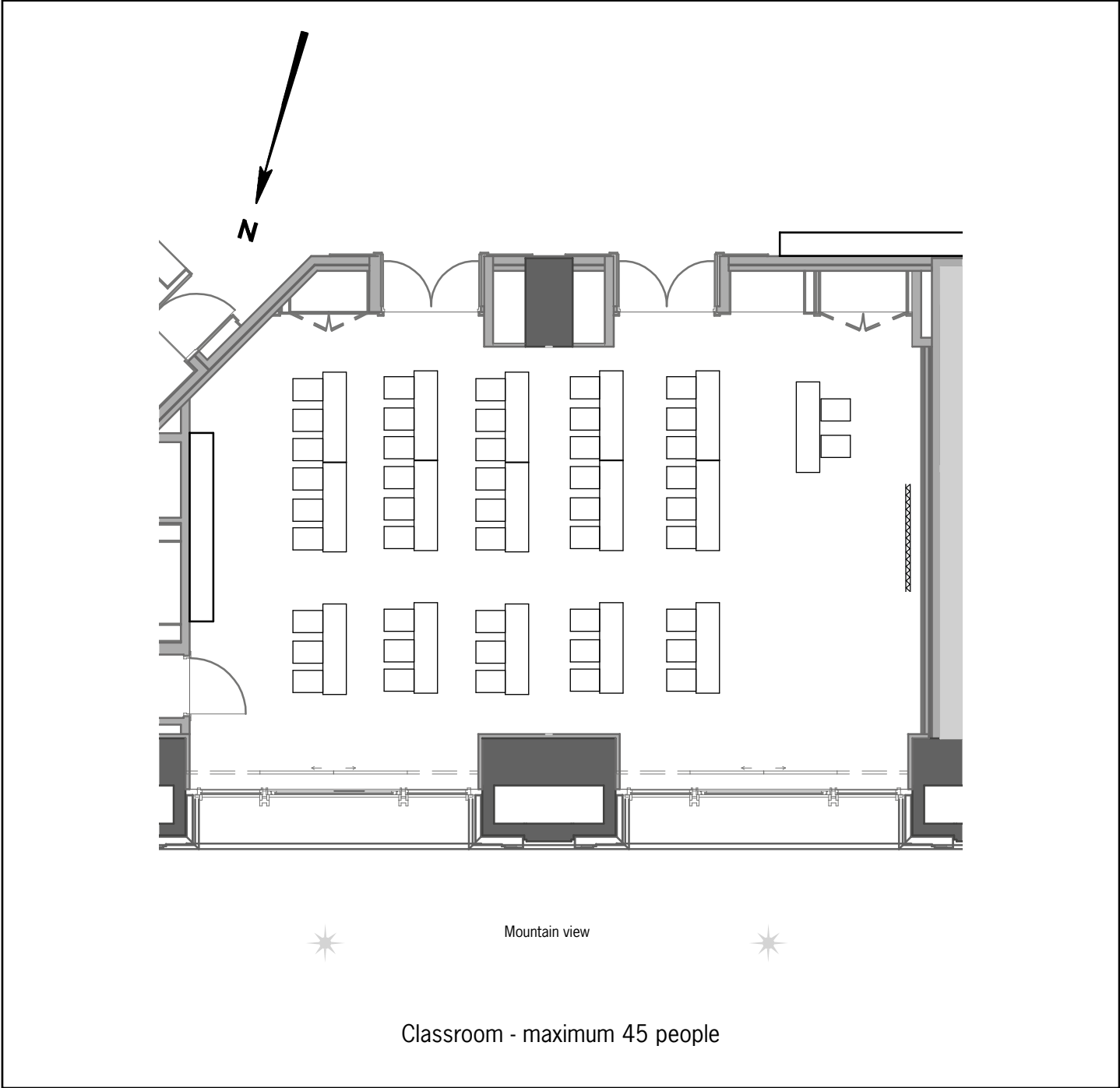

For technical information, please refer to general floorplan (without set-up)

Scale : 1/100

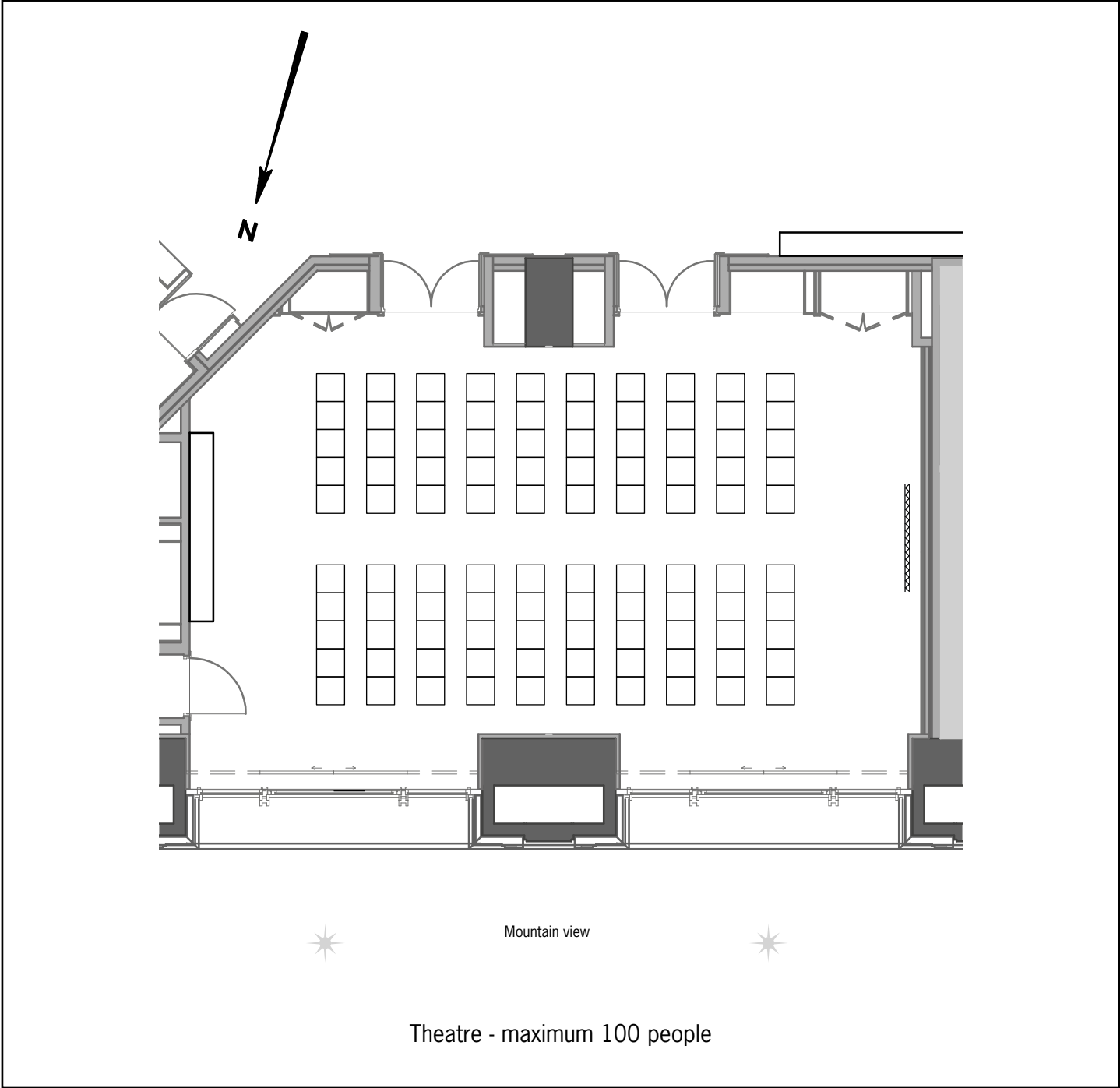

For technical information, please refer to general floorplan (without set-up)

Scale : 1/100

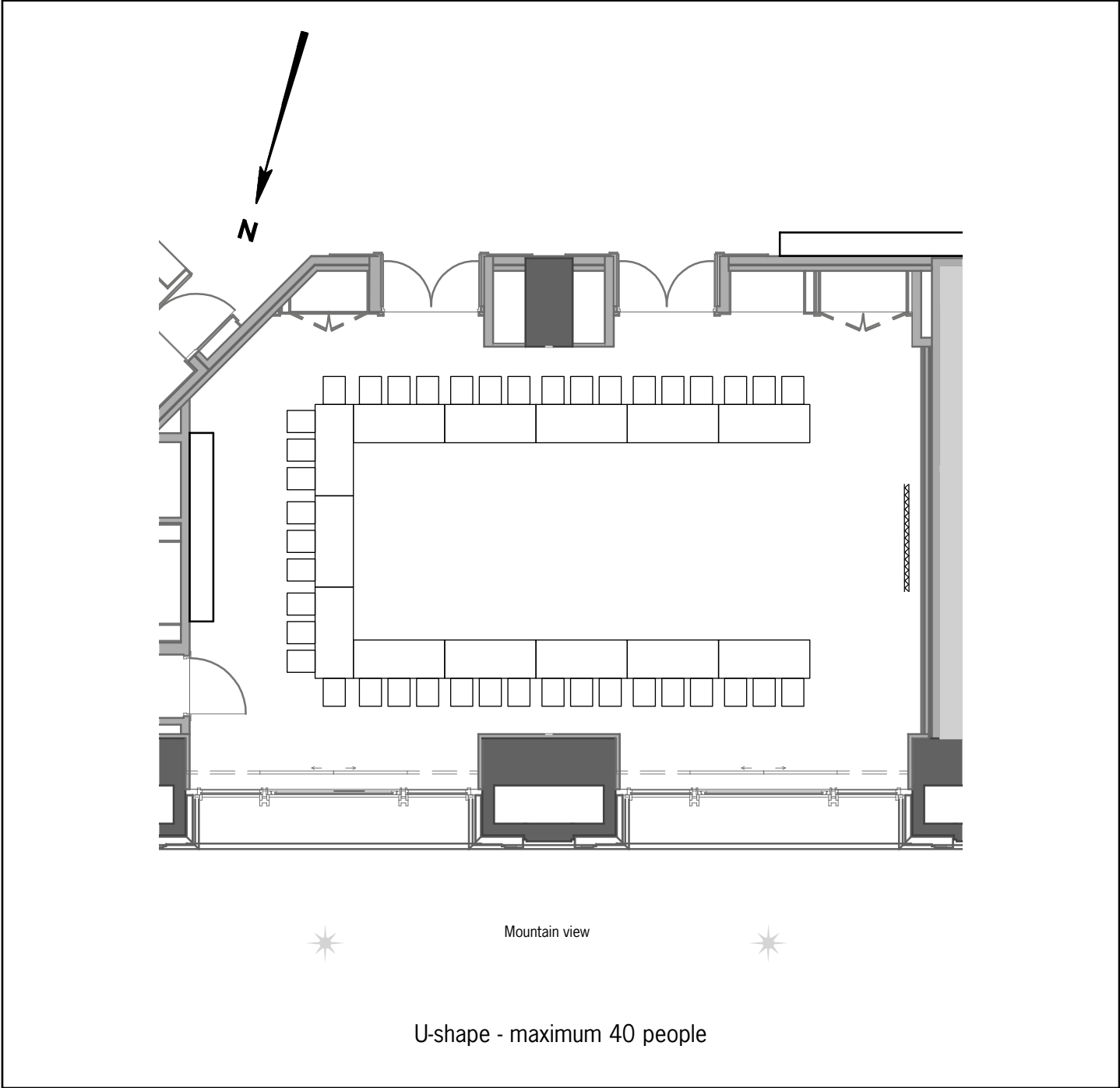

For technical information, please refer to general floorplan (without set-up)

Scale : 1/100

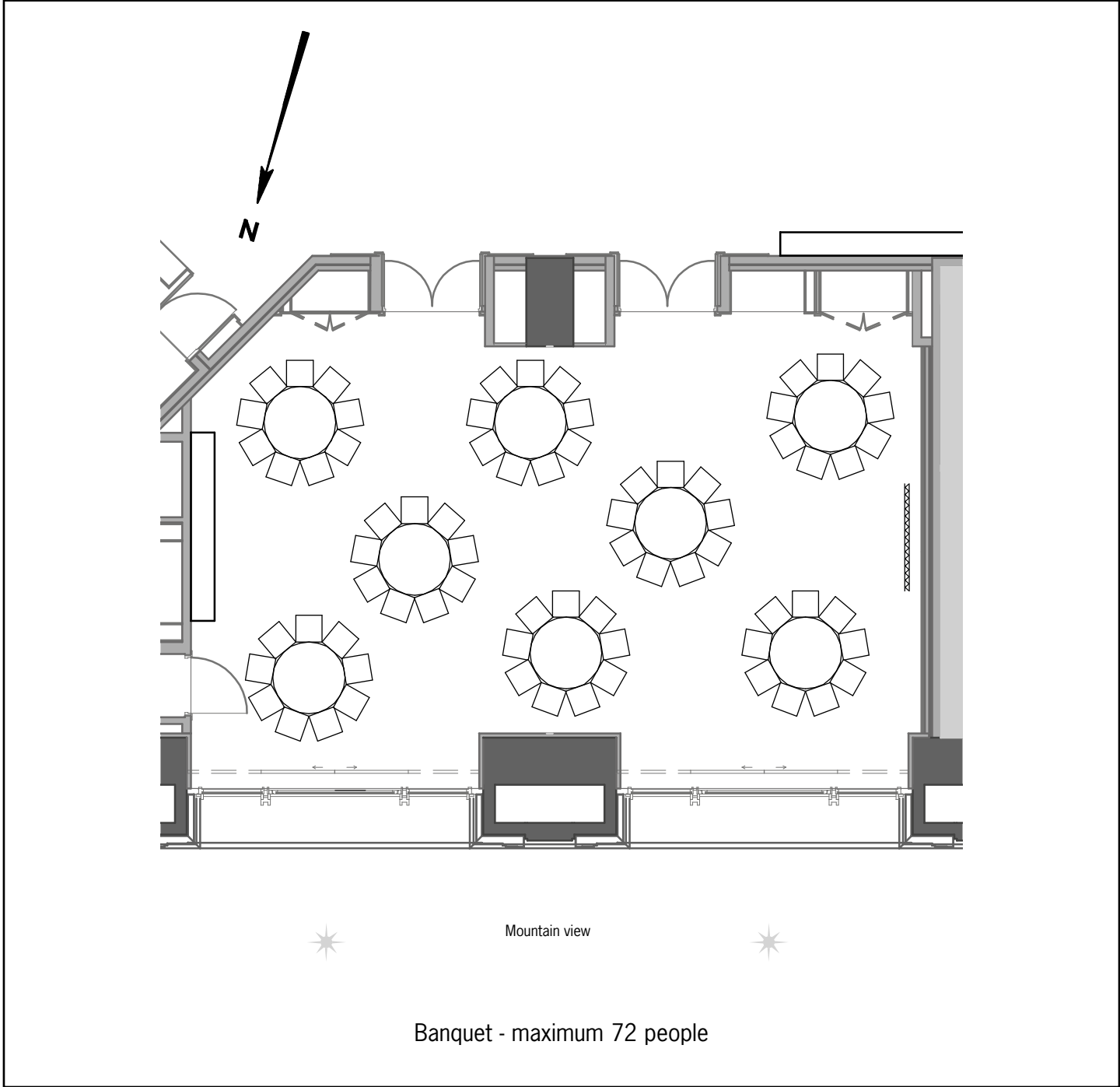

For technical information, please refer to general floorplan (without set-up)